

Quick start guide

Power on/off

Long-press for 3s at the Starting point (note orientation) or under Marker to turn on/off.



Charging

Please charge the robot or replace the battery promptly if the power level is below 10%.



Delivery

Choose table number and click Start to deliver.

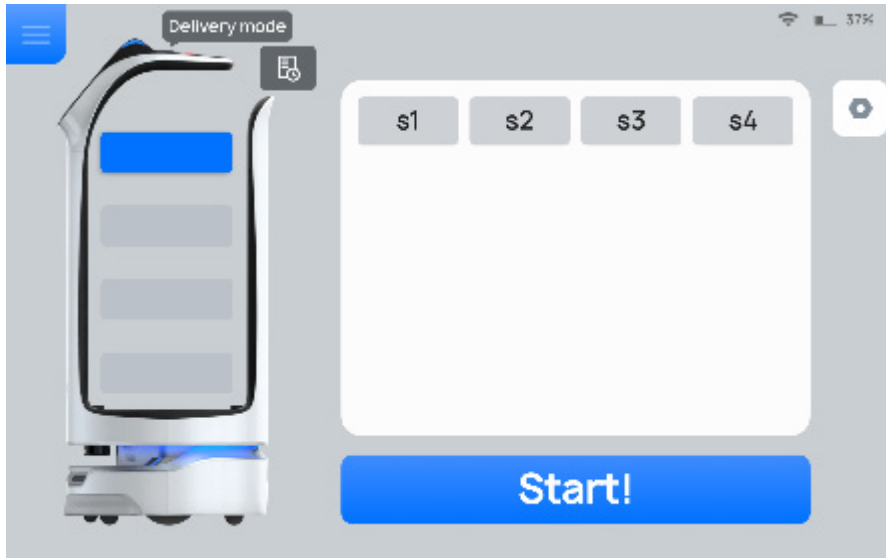

Cruise Mode

Please select the route to cruise.

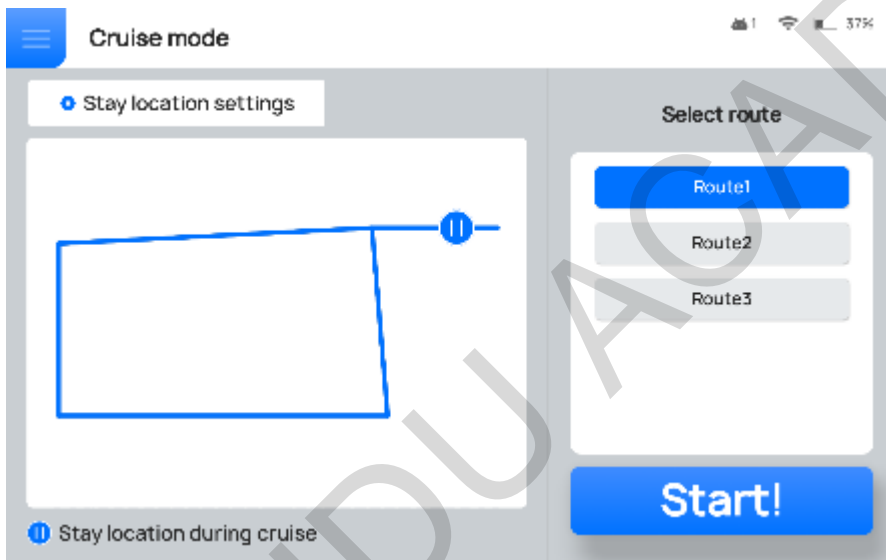

Direct Delivery

One arrival point and one-way delivery.



Guiding

AI interactions, guiding, or go to greeting point.



Birthday

To deliver cakes and gifts with the Birthday Song.



Special mode

For special scenes like wedding proposal, deliver with special music and words.

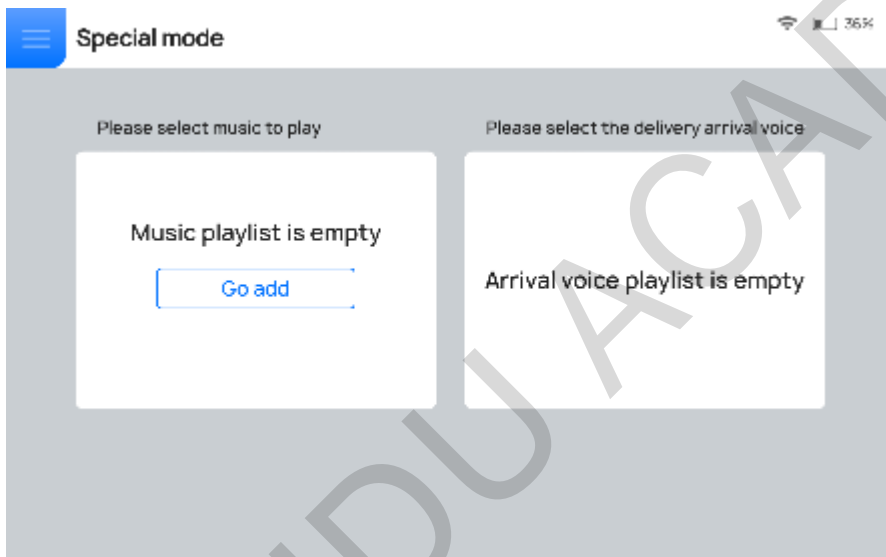

Pause

Click screen or press the function-button to pause.



Setting

To change language, map, speed and volume.

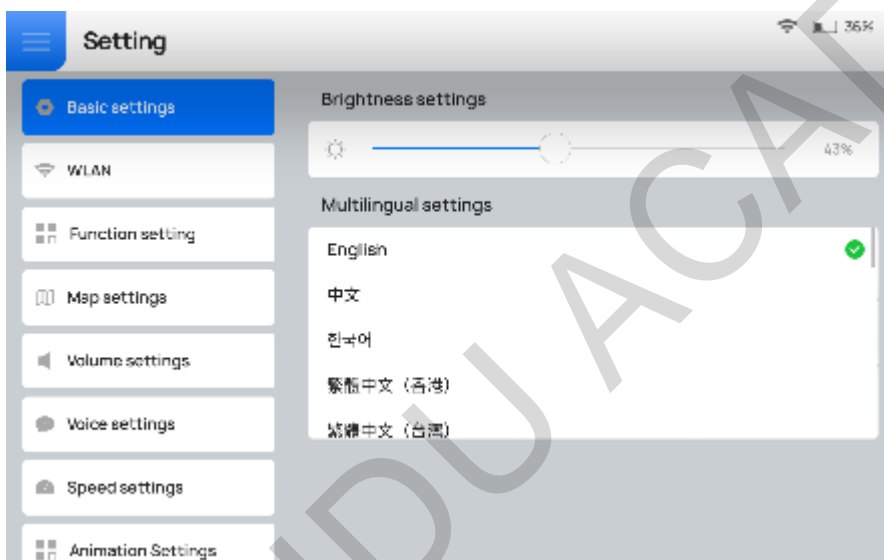

Note

1. Emergency stop: Press the red button on the top to stop the robot immediately and restore by rotation and ejection.
2. Do not to deliver liquid dishes, such as soup or hot pot, which may spill on the trays and cause other accidents.
3. Do not block the robot while it is moving, so as to avoid safety accidents.
4. Do not obscure the radar, RGBD or marker camera with any foreign objects.
5. Please designate a person responsible for charging the robot strictly regulating the charging operation.
6. Please keep the robot dry and at room temperature for storage and charging. Do Not charge at $>40^{\circ}\text{C}$ and avoid water.