



Dishwasher Installation for the CK36ELGLASSNRCKR Kitchenette

This instruction sheet is to demonstrate how to install the included dishwasher safely and securely into your combo kitchen.

1. Place the included mounting brackets (L/R) on top of the dishwasher as shown in the image to the right.

NOTE: The mounting brackets are located inside the dishwasher installation kit and are packaged with the dishwasher.

2. Before placing the dishwasher inside the kitchenette, make sure the top of the dishwasher reaches the countertop. Elevate the dishwasher using the unit's adjustable feet. (Refer to the dishwasher's installation guide for more information.)

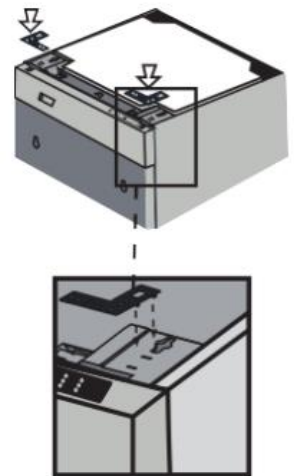

3. Insert the dishwasher into the kitchenette. As you push the dishwasher back into the combo kitchen, make sure to tuck the hoses into the channel at the bottom rear of the dishwasher. There should be sufficient room for both hoses when the dishwasher is pushed back to be flush with the front of the combo kitchen.
4. Open the dishwasher's door and using a Phillips 2 drill bit, drill the two included self-tapping screws to connect the mounting bracket to the top of the kitchenette's metal countertop to complete the installation.