

Quick Start Manual



 **Speed Queen.**

Welcome

Welcome to the Speed Queen® family. Thank you for your support of our truly commercial quality products. Our washers and dryers are expertly engineered to deliver commercial performance, tested to ensure ultimate durability and built with American Pride. For more than 110 years, Speed Queen consumer laundry products have been manufactured in Ripon, Wisconsin, a place where pride of workmanship is not just alive, but thriving and embodied by each individual who designs, tests, assembles or in some way touches a Speed Queen product. A special thing happens when that pride is combined with the highest quality commercial materials and components...it leads to the ultimate reliability...reliability measured in decades, not years. That's legendary Speed Queen Quality.

Installation - Washer

Parts included:

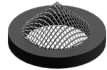

Two (2) filter
screen washers



Two (2) plain
rubber washers



Four (4) rubber
feet



Beaded strap



Standpipe adapter

1. Remove shipping brace and shipping plug.
2. Wipe out inside of washtub.
3. Connect fill hoses – water pressure = 20-120 psi [138-827 kPa].
 - Two required, sold separately
 - Flush water supply lines
 - Use two filter screen washers with screen facing faucet
 - Use two rubber washers in end of hose connecting to the machine
4. Connect drain hose to drain receptacle – 36 in. [91 cm] recommended height.
 - Use beaded strap to secure drain hose to drain receptacle
 - Use standpipe adapter only if standpipe diameter is 2 in. [51mm] or less
5. Position and level washer – adjust front two legs. Tilt washer forward and back to set rear legs.
 - Place four rubber feet on leveling legs
6. Connect washer to electrical power – on individual branch circuit. Refer to serial plate for electrical ratings.
7. Run washer through one complete cycle to make sure it is operating properly.
8. Check for leaks.

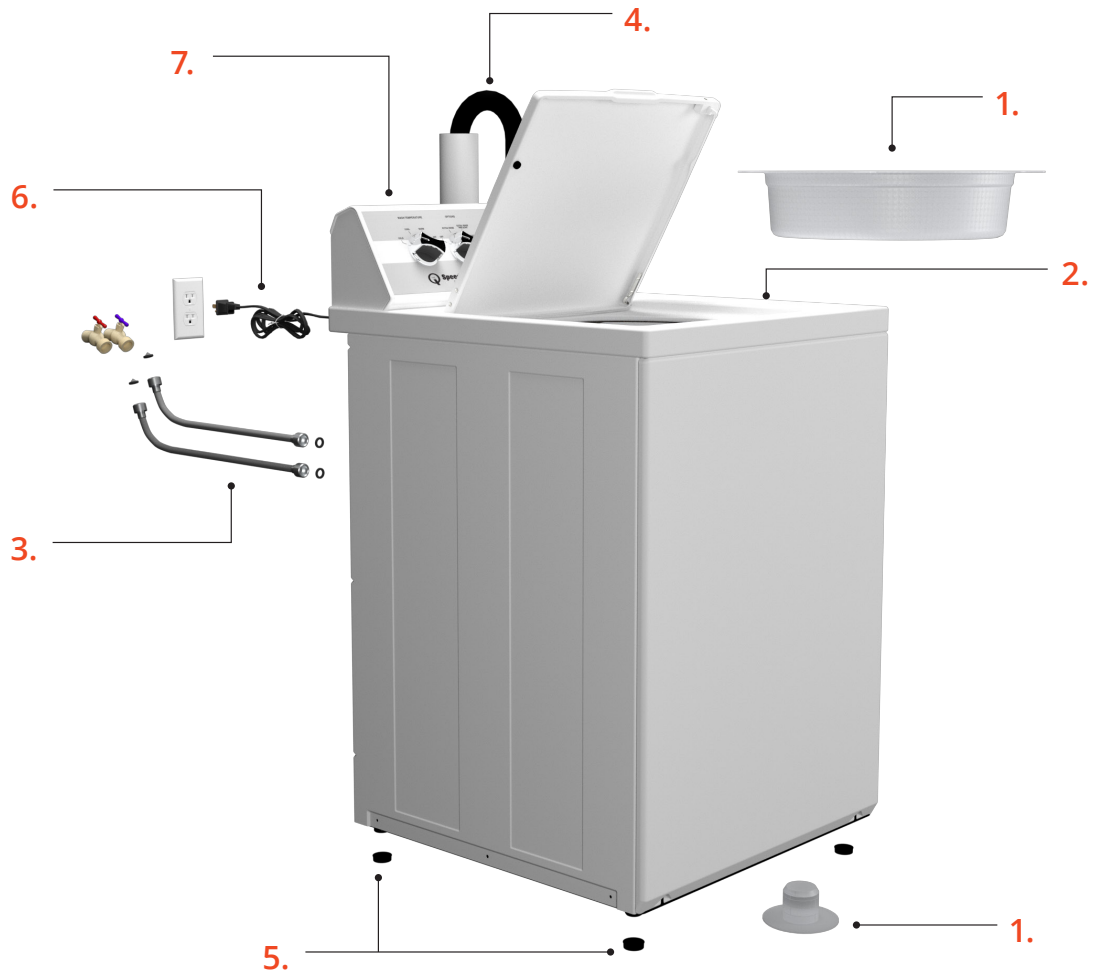

Installation - Dryer

Parts included:



Three (3) Screws
(Electric Models)



Lint Filter Guard
(Optional)

1. Position and level the dryer.
 - Recommended rear clearance minimum is 2 in (51 mm) for utility connections and 6 in (152 mm) when venting through rear of unit
2. Connect exhaust system.
 - Dryer must be exhausted to the outdoors
 - Use 4 in (102 mm) rigid duct
 - Maximum straight duct length = 65 ft (19.8 m). Each elbow deduct 10 ft (3 m)
 - Sufficient make-up air must be supplied. The free area of any opening for outside air must be at least 40 in² (25806 mm²) per unit
3. Gas models – connect gas supply pipe. Gas service to a gas dryer must conform with the local codes and ordinances.
Refer to installation instructions, which can be found at speedqueendoc.net
 - Tighten all connections securely but do not overtighten to avoid breaking or bending the gas valve bracket.
Turn on gas and check all pipe connections (internal and external) for gas leaks by applying a non-corrosive leak detection fluid to the fittings. If bubbles are present then a leak is likely.
Retighten connections and recheck for leaks.
4. Electric models – connect electrical cord with three-wire or four-wire plug.
Refer to installation instructions, which can be found at speedqueendoc.net
5. Wipe out inside of dryer.
6. Plug in the dryer.
7. Start dryer and check that dryer is heating.

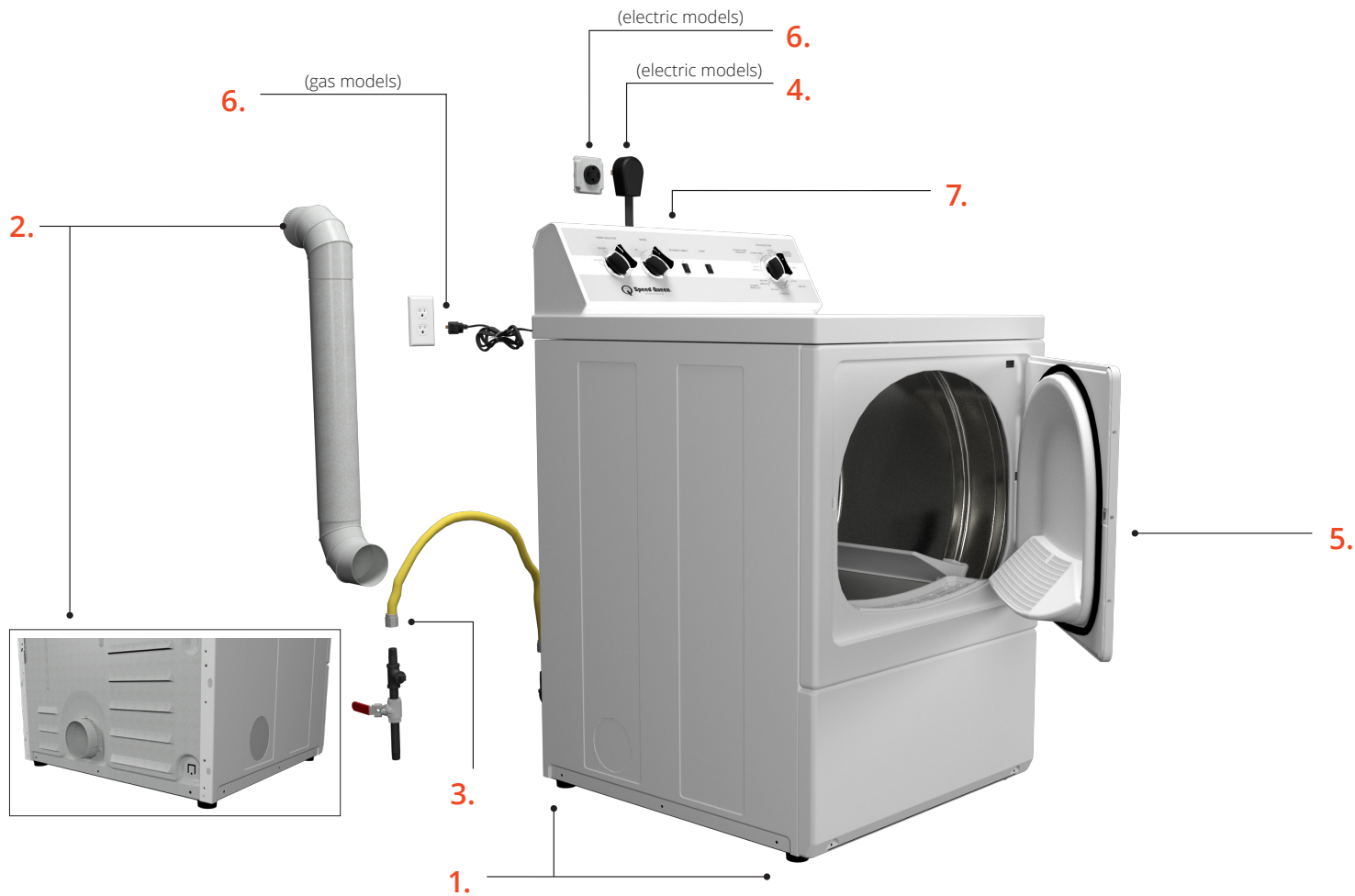

Operating - Washer



1. Prepare laundry



2. Add laundry supplies
Fabric Softener



3. Load laundry



4. Close lid



5. Set cycle

6. Set temperature

7. Set options

8. Press start/pause

NOTE: The Normal Eco Cycle is designed for providing an eco-friendly solution for washing everyday cottons and linens. You will notice that this cycle uses less water and less hot water than other cycles. These functions are unique to the Normal Eco Cycle. All other cycles and options have no temperature restriction and use a full tub rinse.

* *Bacteria tested by an independent lab were Staphylococcus aureus, Pseudomonas aeruginosa, Klebsiella pneumoniae. Individual results may vary.*

Operating - Dryer



1. Prepare laundry



2. Clean lint filter by wiping lint out of screen area (if using lint filter cover, remove first)



3. Load dryer half full with laundry



4. Close door



5. Set cycle

6. Set fabric selector

7. Set extended tumble, if desired

8. Press start button to start

9. Remove laundry from dryer once cycle has ended

NOTE: To Sanitize your laundry load and kill 99.9% of common household bacteria*, set the Fabric Selector to Regular, set the Cycle Selection to Max Dry, and allow the dryer to complete the cycle uninterrupted.

Register

1. Register your product at www.speedqueen.com to take full advantage of the limited warranty.



5 Year Warranty.
Covers all parts and in-home labor.

Note: This unit includes a limited warranty. Refer to Speedqueendoc.net to download the full warranty bond.

2. Download full documentation and view installation and operating videos for an immersive experience at Speedqueendoc.net or scan the QR code below.

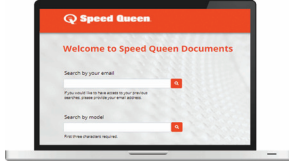

3. If you wish to receive printed documents at no cost, please complete the order form and return by mail to the address on the form, or email your request to technicalcommunications@alliancels.com.

Order Form for Printed Documentation

- Please send me a printed Installation Manual, User's Guide, and Warranty Bond.
- I understand this card does not register my product. I must go to www.speedqueen.com to register.

Model No. _____

Serial No. _____

Name _____

Address _____ City _____ State _____

Zip Code _____ Phone No. _____

Email Address _____

Allow 1-2 weeks for delivery.



Part No. D518284R1
January 2021

© Published by permission of the copyright owner - DO NOT COPY or TRANSMIT
Speed Queen by Alliance Laundry Systems



NO POSTAGE
NECESSARY IF
MAILED IN THE
UNITED STATES

BUSINESS REPLY MAIL

FIRST CLASS MAIL

PERMIT NO. 489

RIPON, WI

POSTAGE WILL BE PAID BY ADDRESSEE

SPEED QUEEN

TECHNICAL DOCUMENTATION

SHEPARD STREET

P O BOX 990

RIPON WI 54971-9967

