







**Please read the instruction manual and save it for future reference.**

** To reduce the risk of fire, electric shock or injury to persons during the use of your appliance, follow the basic precautions, including the following:**

- Before using the product for the first time, please read all instructions and save them for future reference.
- Instructions for use are available on our website at [www.asko.com](http://www.asko.com).
- The product is intended solely for household use.
- Do not repair and do not attempt to replace any part of the product or to service it in any other way, unless this is expressly recommended in the instructions for use and maintenance or in the instructions for user repairs. Also, do not attempt any repairs or servicing if you do not understand the instructions entirely or if you lack the skills for such repairs.
- Any product repair and maintenance pertaining to safety or performance should be done by trained experts.
- In case of incorrect use or product servicing by an unauthorized person, the user shall be solely responsible for covering any damage or expenses.
- Do not allow children to play with the product or on the product. Watch children closely when you are using the product near them.
- The product is not intended for use by persons (including children) with impaired physical or mental capabilities or lack of experience and knowledge. Such persons should be instructed on safe use of the product by the person responsible for their safety.
- Do not let children younger than three years come near the appliance, unless they are under constant supervision.
- Do not install or store the product in places where it could be exposed to the elements.

The following symbols are used throughout the manual and they have the following meanings:

	Information, advice, tip, or recommendation
	Warning – general danger
	Warning – danger of electric shock

# INSTALLATION AND USE OF A PEDESTAL DRAWER



The pedestal drawer may only be used with a washing machine and a dryer by the manufacturer Asko Appliances.

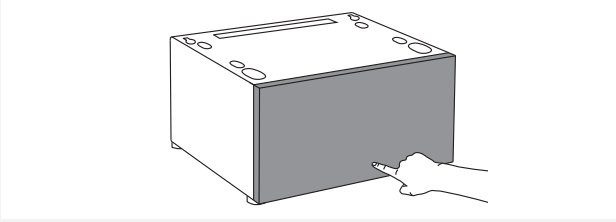

**1** Press on the pedestal drawer to open it.

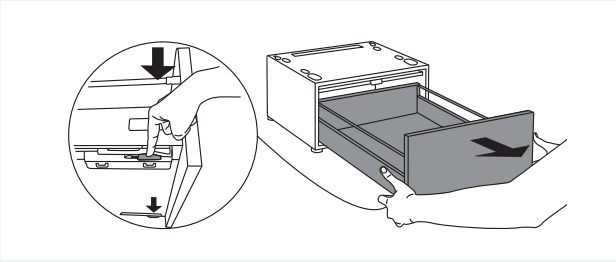

**2** Use both hands to pull out the pedestal drawer towards you. Then, push the plastic levers located on the drawer guides under the drawer on each side towards the middle in order to release the stop preventing the drawer from being pulled out completely.

Pull out the entire pedestal drawer.

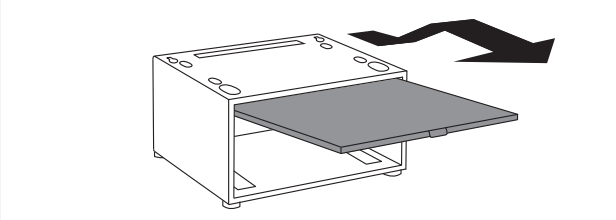

**3** Pull out the shelf in an upward arc.

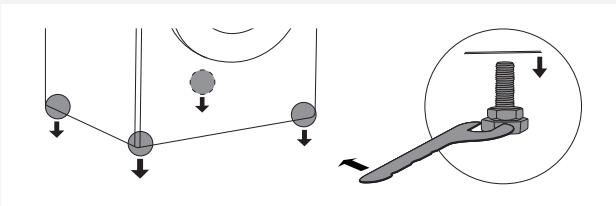

**4** Tilt the washing machine or dryer to either side, and use a wrench (22 mm) to remove the metal feet.

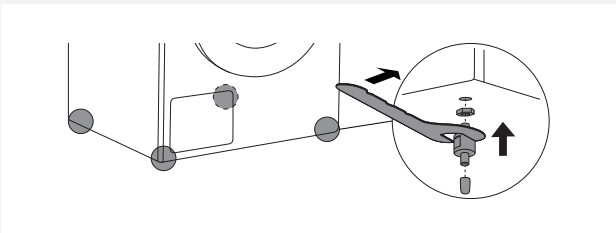

**5.1** Attaching the spacers to the washing machine.

First, screw the supplied nuts onto the spacer. Then, use an open spanner (22 mm) to attach the spacers to the spot where the metal feet were previously attached.

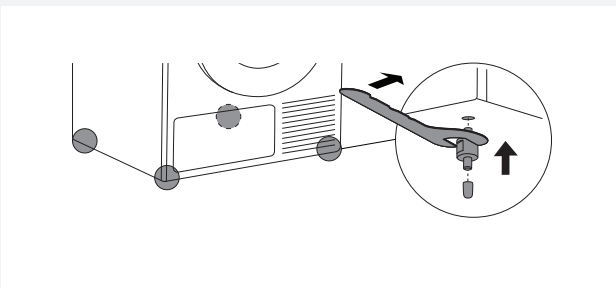

**5.2** Attaching the spacers to the dryer.

Use an open spanner (22 mm) to attach the spacers to where the metal feet were previously attached.

Attach the rubber caps onto the spacers in order to protect your floor during installation.

Tilt the machine to the other side and repeat steps 4 and 5.



The pedestal drawer is intended solely for installation under an appliance. The drawer can only support the weight of one appliance. If a pedestal drawer is installed under a washing machine, do not install a dryer onto the washing machine, or vice versa.

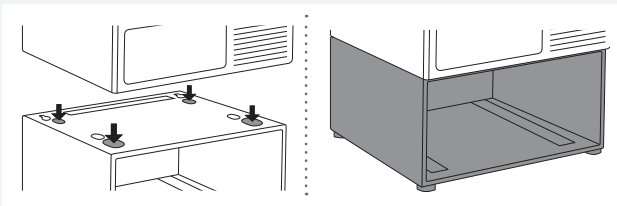

**6** Lift the washing machine or dryer and place it over the pedestal drawer. Place the pedestal drawer and make sure it is aligned with WM (washing machine) or TD (tumble dryer).

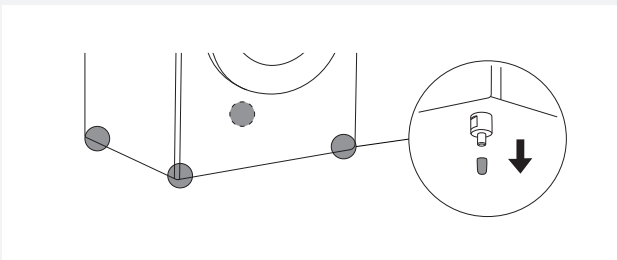

**7** Remove the rubber caps.

Then, replace the drawer (see steps 10 and 11) and make sure the washing machine and dryer are level. Adjust their position if necessary.

When the position is set, remove the pedestal drawer.

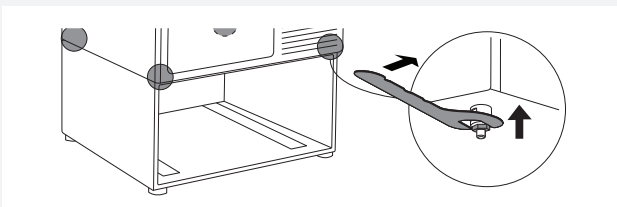

**8** Attach the nuts to all four spacers on the washing machine or dryer, and tighten them with an open spanner (17 mm).

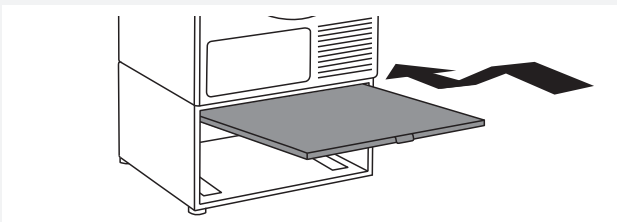

**9** Replace the pull-out shelf.

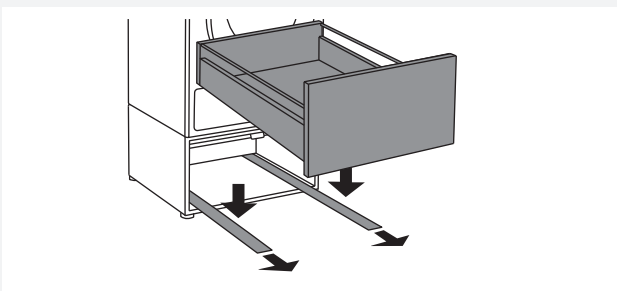

**10** Pull out both guides and place the pedestal drawer onto the guides.

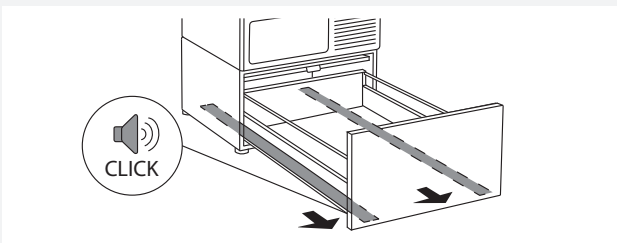

**11** Use the plastic stops under the guides to pull the guides towards you until you hear the guides "CLICK" into place.

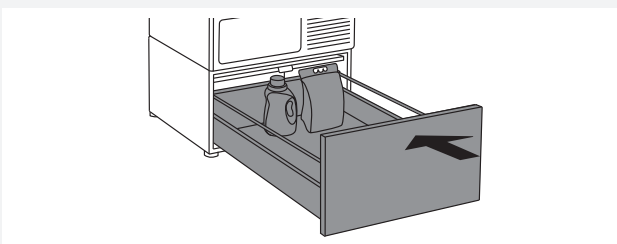

**12** The pedestal drawer can be used as storage space for a variety of objects (e.g. washing detergent or conditioner). After use, close the pedestal drawer.