

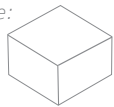

Craft
Cube:



Stainless Solid



Integrated Solid

BrightShield® vuv
Antimicrobial Light

BrightShield® protects against viruses, bacteria, mold, & mildew.



Key Features

- **Industry-exclusive slow melting clear ice cubes perfect for whiskeys and cocktails**
- **High production rate of 160 cubes per day**
- **Up to 25 lbs in ice storage capacity**
- **Industry leading BrightShield® antimicrobial lighting creates a clean environment for ice**
- Designed for built-in or freestanding applications
- Easy clean process only lasts 45 minutes
- Environmentally friendly R600a refrigerant (1.976 oz)
- Factory installed drain pump
- Field reversible door is shipped right-hand hinged
- Four adjustable leveling legs
- High efficiency variable speed compressor with 1.7 running amps
- Ice scoop included
- Indicator alert notifies when cleaning is needed
- Integrated model requires 3/4" custom door panel and handle (not supplied by U-Line)
- Makes square cubes 1 7/8" L x 1 7/8" W x 1 1/4" H
- Silent setting temporarily suspends ice making for 3 hrs
- Soft close door with articulating hinge
- Stainless steel handle (7/8" diameter)

Model Details

| Model | Description | Voltage/Hz | Shipping Weight |
|---------------|---|-------------|-----------------|
| URCC115-SS81A | Craft Clear Ice Machine 15" Reversible Hinge Stainless Solid | 115v / 60hz | 125 lb |
| URCC115-IS81A | Craft Clear Ice Machine 15" Reversible Hinge Integrated Solid | 115v / 60hz | 121 lb |

Accessories

| Accessories | Description | Shipping Weight |
|----------------|---|-----------------|
| ULAWATERHOOKUP | Braided Water Supply Line Kit | 2 lb |
| 80-55667-00 | Clear Ice Machine Cleaner (Single 4 oz. Bottle) | 1 lb |

Front

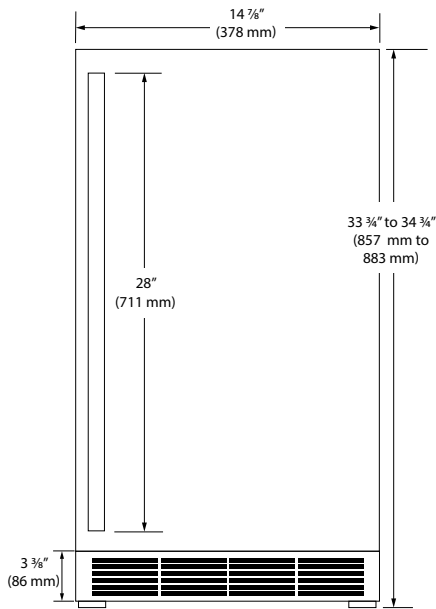

Side

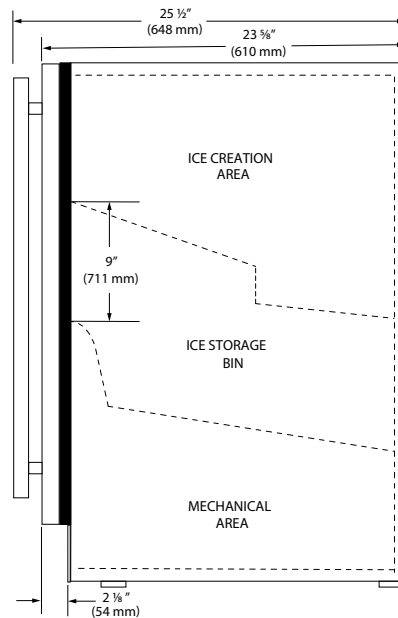

Top

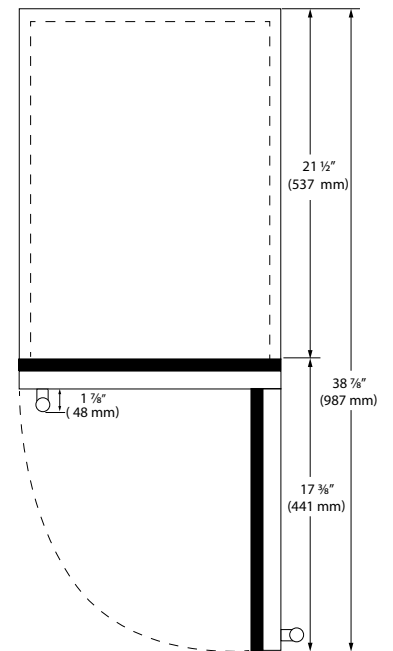

Specifications

| | |
|----------------------------|---------------------------------------|
| Model | RCC115 |
| Amps: Running | 1.7 |
| Dimensions: Product Depth | 23 3/4" / 600 mm |
| Dimensions: Product Height | 33 3/4" to 34 3/4" / 857 mm to 883 mm |
| Dimensions: Product Width | 14 3/4" / 375 mm |
| ENERGY STAR | No |
| Ice Production Per Day | 160 Cubes |
| Ice Storage | 25 lb |
| Panel Height | 30 7/16" / 773mm |
| Panel Thickness | 3/4" 20mm |
| Panel Type | Solid Panel |
| Panel Width | 14 3/4" / 375 mm |
| Product Weight: Max | 122 lb |
| Refrigerant Type: | R600a |

Back

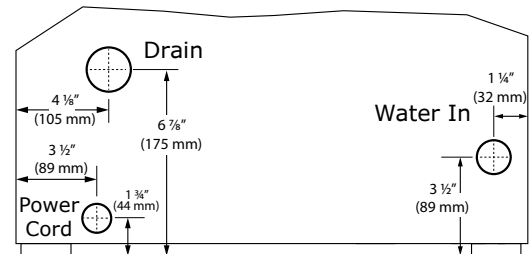

Cabinet Cut-Out

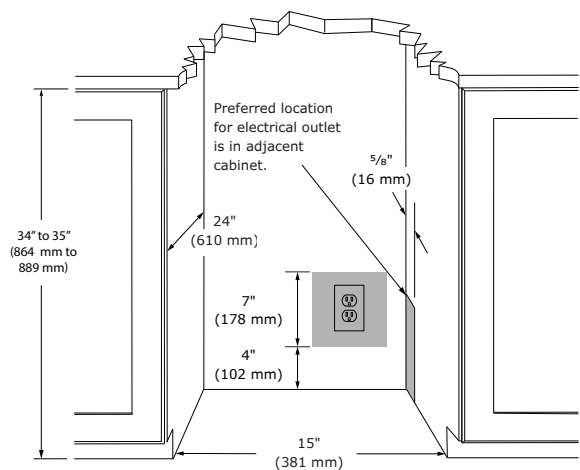

Installation Notes

- No additional clearance is needed for ventilation
- Do not obstruct front grille air flow

Warranty

- 1 Year (parts & labor) / 5 year sealed system (parts)

+ **Additional 1 year (parts & labor) warranty at no cost with product registration.**

See complete warranty for details

