

# DRYER QUICK START GUIDE

## OPERATING INSTRUCTIONS

**WARNING**



**Fire Hazard**

No washer can completely remove oil. Do not dry anything that has ever had any type of oil on it (including cooking oils). Items containing foam, rubber, or plastic must be dried on a clothesline or by using an Air Cycle. Failure to follow these instructions can result in death or fire.

**WARNING**



**Explosion Hazard**

Keep flammable materials and vapors, such as gasoline, away from dryer. Do not dry anything that has ever had anything flammable on it (even after washing). Failure to follow these instructions can result in death, explosion, or fire.

**WARNING:** To reduce the risk of fire, electric shock, or injury to persons, read the IMPORTANT SAFETY INSTRUCTIONS, located in your appliance's Owner's Manual, before operating this appliance.

## Button Descriptions

### 1. POWER/CANCEL

Touch to turn the dryer on and off. Touch to stop/cancel a cycle at any time.

### 2. START/PAUSE

Touch and hold until LED counts down "3-2-1" and the dryer starts; then let go to start a cycle, or touch once while a cycle is in process to pause it.

### 3. MODIFIERS

Use to select available modifiers for your dryer. Not all cycles and options are available on all models. See the online "Cycle Guide" for details.

### Temp

When using Timed Dry/Quick Cycle, you may select a dry temperature based on the type of load you are drying. Use the warmest setting that is acceptable for the garments in the load. Follow garment label instructions.

**NOTE:** Automatic Cycles will give you up to 4 temperatures to adjust, depending on the selections that have been made.

### Drying Levels

You may adjust the Dryness on Automatic Cycles (except for the Sanitize cycle), if desired.

**NOTE:** Dryness is for use with Automatic Cycles only.

### More Time/Less Time

Touch More Time or Less Time with Timed Dry/Quick Dry Cycles to increase or decrease the length of the cycle.

### 4. OPTIONS

Use to select available options for your dryer. Not all cycles and options are available on all models.

### Wrinkle Shield™ Option

If you will be unable to remove a load immediately, touch Wrinkle Shield™ to add up to 150 minutes of periodic tumbling to help reduce wrinkling. You may select the "+ Steam" setting (on some models only) to add a short steam cycle after 60 minutes to help smooth out wrinkles.

**NOTE:** If you open the dryer door prior to the end of the Wrinkle Shield™ option, the dryer will pause.

### Steam Refresh (steam models only)

This cycle is best for reducing wrinkles and odors from dry items. Cycle time will increase, depending on number of items. This is an independent cycle that cannot be combined with any other cycle.

### Cycle Signal

Use this to turn the signal indicating the end of a drying cycle to low, medium, high, or off. The volume you select here will also be applied to the Damp Dry Signal.

**NOTE:** You may also turn off the tones that sound when a feature, setting, or option is touched. Touch and hold Cycle Signal for about 3 seconds to turn sounds to low, medium, high, or off.

### Damp Dry Signal

Touch to select the Damp Dry Signal on or off. When selected, a series of beeps will sound when the load is damp, but not completely dry. This will allow you to take clothes out of the load that do not need to dry completely. The Damp Dry Signal is selected as a default for the Bulky Items cycles, as a reminder to manually reposition bulky loads midway through the cycle. This option is not available for all cycles. See the online "Cycle Guide" for details.

## Step 1. Clean Lint Screen

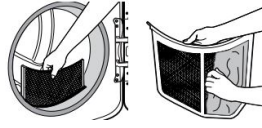

## Step 2. Load Clothes; then Close Door

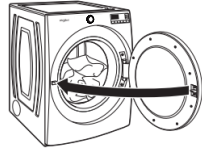

## Step 3. Power On/Cancel



## Step 4. Select Cycle and Settings

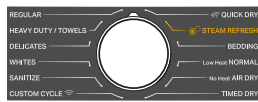

## Step 5. Press Start/Pause



## Cycle Guide

This dryer has a unique user interface to help you select the best cycle you need for your load. The controls layout guides you to the optimal cycle in two easy steps: First determine what items are in the load that you are trying to dry. Use that to guide your selection. Then determine how you want the dryer to dry them and select the appropriate selection. Modifiers are preset for the items being dried, but can be changed if desired.

To get the most energy savings and enhanced fabric care from your dryer, use the Automatic cycles. These cycles measure the drying air temperature and moisture levels to turn the dryer off once the load reaches the selected dryness level. Dryer performance and results may vary with service voltage less than 240.

Items to Dry:	Cycle:	Dryness Level:	Description:
Baby clothes, Blankets, Cotton undergarments, Colored napkins	Regular Bulky Items Whites Sheets Colors	Normal	Automatic Sensor cycle stops when dryness level is reached. See online "Cycle Guide" for details.

**NOTE:** These clothes dryer's Government energy certifications were based on the Low Heat Normal Cycle, EcoBoost Defaulted ON, Highest Temperature and Normal Dryness Level. The as-shipped defaults of Low Heat Normal, EcoBoost ON, Medium Temperature and Wrinkle Shield Off were used. Cycles that are available for post-sale download may use more energy than the Low Heat Normal cycle, upon which the energy use rating of this dryer is based upon.

## Online Ordering Information

For detailed installation instruction and maintenance information, winter storage, and transportation tips, please see the Owner's Manual included with your machine.

For information on any of the following items, a full cycle guide, warranty, detailed product dimensions, or for complete instructions for use and installation, please visit [www.whirlpool.com/owners](http://www.whirlpool.com/owners), or in Canada [www.whirlpool.ca/owners](http://www.whirlpool.ca/owners). This may save you the cost of a service call.



[Register Product](#)



[Add Service Plan](#)



[Schedule Service](#)



[Parts](#)



[How To's & FAQ](#)



[Filters](#)



[Manuals & Downloads](#)



[Accessories](#)

However, if you need to contact us, use the information listed below for the appropriate region.

United States:  
**1-866-698-2538**

Whirlpool Brand Home Appliances  
Customer eXperience Center  
553 Benson Road  
Benton Harbor, MI 49022-2692

Canada:  
**1-800-807-6777**

Whirlpool Brand Home Appliances  
Customer eXperience Centre  
200-6750 Century Ave.  
Mississauga, Ontario L5N 0B7

**IMPORTANT:** Retain this guide for future use.

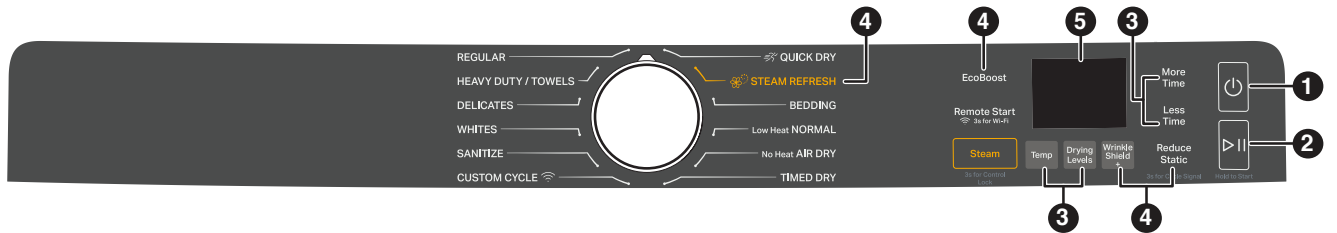

Not all features, cycles, and options are available on all models. Appearance may vary.

**NOTE:** The control panel features a sensitive surface that responds to a light touch of your finger. To ensure your selections are registered, touch the control panel with your finger tip, not your fingernail. When selecting a setting or option, simply touch its name.

### Reduce Static (on some models)

Touch to add this option to selected Automatic Cycles. The dryer will automatically tumble, pause, and introduce a small amount of moisture into the load to help reduce static. This option adds approximately 3 minutes to the total cycle time.

### Control Lock

Use this option to lock the controls of the dryer and avoid an accidental unintended change in cycle options or preferences during a drying cycle. Touch and hold Control Lock or Damp Dry Signal (depending on the model) for 3 seconds to lock or unlock the controls of the dryer. During this time, the LED Display will count down "3-2-1." Once the controls are locked, the LED Display will display "Loc."

**NOTE:** The Control Lock function may be enabled when recovering from a power failure. To unlock the control, touch and hold Control Lock or Damp Dry Signal (depending on the model) for at least 3 seconds.

### EcoBoost™ Option

The EcoBoost™ option will default on only for the Regular/Normal cycle and is only available on that cycle. This option allows you to increase your energy savings by using a slightly lower heat level. The EcoBoost™ option will increase drying times by approximately 40 minutes, which will be reflected on the LED display. If optimal time is desired, touch ECOBOOST to turn off this option.

### 5. LED DISPLAY

When you select a cycle, its default settings will light up and the estimated time remaining (for Automatic Cycles) will vary depending on selections or actual time remaining for Timed Dry cycles (for Manual Cycles) will be displayed.

### CYCLE STATUS

The Cycle Status indicators show the progress of a cycle. Not all indicators are available on all models.

### Sensing

The Sensing indicator will light periodically during Sensor Cycles to indicate that the moisture sensor on the dryer is operating. This indicator will not light during Timed Cycles or options such as Wrinkle Shield™ Option.

### WiFi Connect

Touch and hold WiFi Connect for 3 seconds during the initial connection of the dryer to your home Wi-Fi network. If the dryer is in a Smart Delay, touch WiFi Connect to override the delay and begin a dry cycle immediately.

### Remote Enabled

Press the Remote Enable button any time you want to use the WiFi app. Pressing the button locks out the LCD screen and you will be prompted with a message about the dryer waiting for input from the app. To exit this mode, press the Remote Enable button again.

### Wet

The load is still wet and/or the cycle just started.

### Damp

This indicator shows that the load is partially dried and items that you may wish to hang up or iron while still damp may be removed.

### Cool Down

The dryer has finished drying with heat and is now tumbling the load without heat to cool it down and reduce wrinkling.

### Check Vent

The Check Vent indicator is a feature available for Automatic Cycles only. This indicator will show the status of airflow through the dryer and the dryer vent system for the dryer's life. During the sensing phase at the beginning of the cycle, the Check Vent light will come on if a blocked vent or low airflow issue is detected. This light will stay on for the entire cycle. Should the Check Vent light illuminate, refer to the online "Troubleshooting" section for potential solutions to the issue.

The light will be cleared upon completion of the cycle, touching Power, or opening the door. The Check Vent light will continue to illuminate during the cycle unless the root cause is resolved.

**NOTE:** The dryer will continue to operate even while the indicator is lit, but poor airflow can impact dry times and overall performance. See "Check Your Vent System for Good Airflow" in the Owner's Manual.

**NOTE:** If there are other error issues during a cycle, the Check Vent indicator will not light up. See the online "Troubleshooting" section.

### End

This will indicate that the selected cycle has ended and the load may be removed from the dryer. If Wrinkle Shield™ Option has been selected, the dryer may continue to tumble the load, even if "End" is displayed.

### Control Lock



This will illuminate once the controls are locked.