



## Beverage Center

### PRODUCT MODEL NUMBER

WUB50X24HZ

**Electrical:** 115-Volt, 60-Hz, AC-only 15- or 20-amp fused, grounded electrical supply is required. It is recommended that a separate circuit serving only your beverage center be provided. Use an outlet that cannot be turned off by a switch. Do not use an extension cord.

**NOTE:** Before performing any type of installation, cleaning or removing a light bulb, unplug beverage center or disconnect power.

### LOCATION REQUIREMENTS

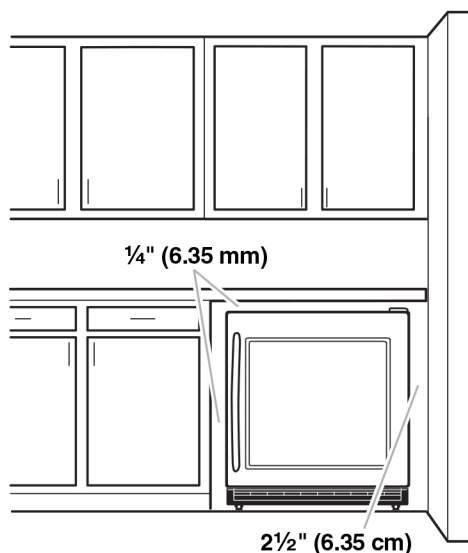

To ensure proper ventilation for your beverage center, allow for a  $\frac{1}{4}$ " (6.35 mm) space on each side and at the top. When installing your beverage center next to a fixed wall, leave  $2\frac{1}{2}$ " (6.35 cm) minimum clearance on each side to allow for the door to swing open.

**NOTE:** It is recommended that you do not install the beverage center near an oven, radiator, or other heat source. Do not install in a location where the temperature will fall below 55°F (13°C). For best performance, do not install the beverage center behind a cabinet door or block the base grille.

### OVERALL DIMENSIONS

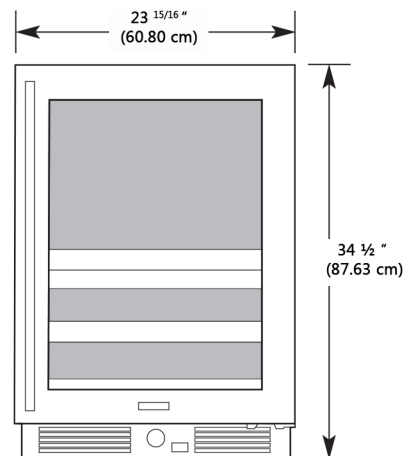

<i>Height to top of cabinet:</i>	34 $\frac{1}{2}$ " (87.63 cm)
<i>Height to top of door hinge:</i>	35" (88.9 cm)
<i>Width closed:</i>	23 $\frac{15}{16}$ " (60.80 cm)
<i>Depth closed including handle:</i>	25 $\frac{5}{8}$ " (65.08 cm)
<i>Depth closed excluding handle:</i>	24" (60.96 cm)
<i>Depth excluding doors:</i>	21 $\frac{5}{8}$ " (54.92 cm)
<i>Depth with doors open 90°:</i>	46 $\frac{1}{4}$ " (117.47 cm)