

Quick Reference Guide

Using Your Front-Loading Washer

NOTE: See your Use and Care Guide for more information. Not all settings and options are available on all cycles.

⚠ WARNING



Fire Hazard

Never place items in the washer that are dampened with gasoline or other flammable fluids.

No washer can completely remove oil.

Do not dry anything that has ever had any type of oil on it (including cooking oils).

Doing so can result in death, explosion, or fire.

What to Wash



Power Button

How to Wash

Start/Pause Button

Cycle Status Display

Cycle Modifiers

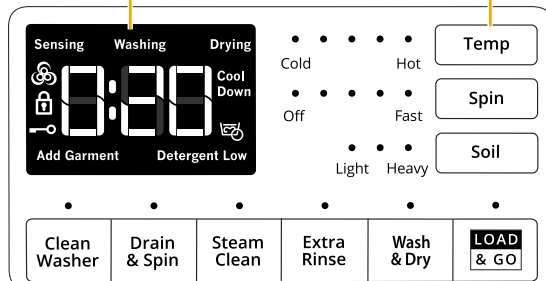

Options

W11340167A
W11340168A - SP

1 TOUCH POWER TO TURN ON WASHER



BEFORE FIRST USE:

2 SET UP LOAD & GO™ BULK DISPENSERS (ON SOME MODELS)

Your washer comes equipped with either a 1-Liter or 2-Liter Load & Go™ bulk dispenser, which allows you to fill with detergent once and skip refills for multiple loads. Use HE detergent only.

To Fill Bulk Dispensers:

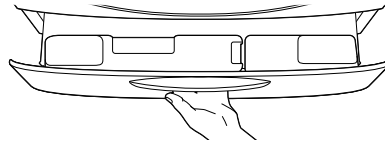

Open the dispenser drawer, gently pull up on the dispenser lid tab, and fill to the "MAX" line. **IMPORTANT:** Do not use chlorine bleach or powdered detergent in the bulk dispenser. Powdered detergent must be added to the single-load dispenser.

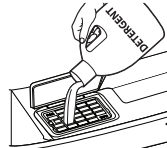

3 RUN WASH CYCLE WITHOUT LAUNDRY

Before washing clothes for the first time, choose the Regular/Quick cycle and run it without clothes. This initial cycle serves to ensure the interior is clean before washing clothes.

DOING LAUNDRY:

4 ADD LAUNDRY PRODUCTS, IF DESIRED

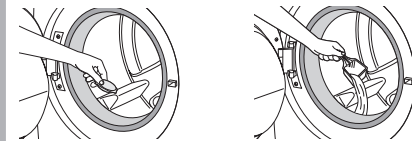

Single-dose laundry packets, Oxi-type boosters, color-safe bleach, or scented crystals can be added to the drum prior to adding laundry. When using single-dose laundry packets, make sure that the bulk dispenser is disabled or off.

5 LOAD LAUNDRY

Place a load of sorted items loosely in the washer.

IMPORTANT: Push load fully into the washer. Make sure no items are resting on the rubber seal to avoid trapping them between the seal and the door window.

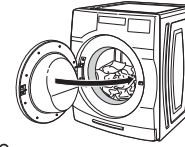

6 ADD HE DETERGENT, IF DESIRED

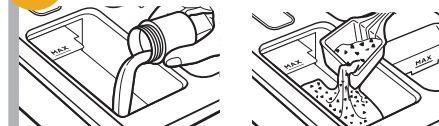

If you choose to use the Single-Load Dispenser instead of the bulk dispenser, add detergent to the appropriate compartment at this time. Touch LOAD & GO™ to disable the bulk dispenser.

7 ADD LIQUID FABRIC SOFTENER AND CHLORINE BLEACH TO SINGLE-LOAD DISPENSER, IF DESIRED

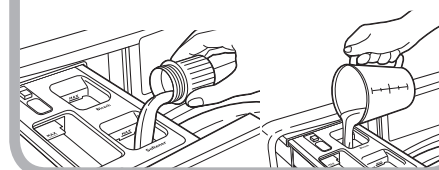

8 SELECT A CYCLE

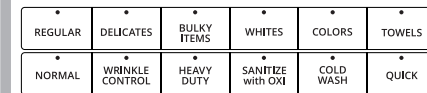

First, choose what you want to wash by touching a selection in the top row. Next, choose how you want to wash your load by touching a selection in the bottom row.

9 ADJUST CYCLE MODIFIERS, IF DESIRED

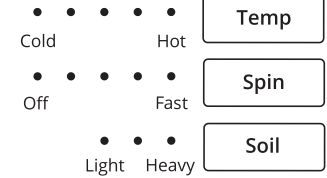

10 SELECT ANY ADDITIONAL OPTIONS

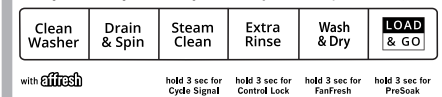

Wash & Dry (on some models): Touch to add a drying cycle to your load after the wash cycle has finished. The Wash & Dry option is designed to wash and dry small loads overnight. This option is design for 2-4 lightly soiled synthetic garments, athletic uniforms, or workout wear. This option has an extra-high-speed spin followed by intermittent tumbling and fan activation to circulate air through the clothes.

11 TOUCH AND HOLD START TO BEGIN WASH CYCLE

Touch and hold START/PAUSE for 3 seconds to start the wash cycle. To pause a cycle in progress, touch START/PAUSE once; then touch and hold again to continue the cycle. To cancel a cycle, touch and hold POWER.



MAINTENANCE

- Run Clean Washer cycle every 30 loads. The washer will also give you a reminder.
- Leave door open for ventilation when machine is not in use.
- Check door seal between cycles. Clean out small items, debris, and/or lint if present.
- Clean drain pump filter occasionally.