

Dishwasher Quick Start Guide

OPERATING INSTRUCTIONS

⚠ WARNING



Tip Over Hazard

Do not use dishwasher until completely installed.

Do not push down on open door.

Doing so can result in serious injury or cuts.

Step 1. Prepare and Load the Dishwasher

IMPORTANT: Remove leftover food, bones, toothpicks, and other hard items from dishes. Remove labels from containers before washing.



Filter Cleaning:

FILTER SHOULD BE REMOVED AND CLEANED EVERY 1 - 3 MONTHS FOR BEST PERFORMANCE.

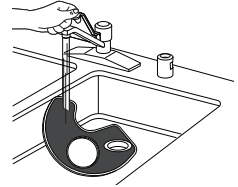
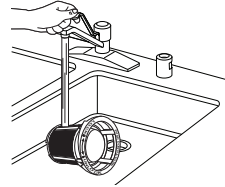

Rinse Filter Cup and Plate under cold water.

To remove filter, pull out lower rack, grasp Filter Cup and rotate counterclockwise. Pull up to remove. Remove the Filter Plate. Rinse both under cold water in sink. A soft brush can be used to remove stuck on food. Replace filter plate. Ensure filter plate is correctly seated under tabs. To install filter cup, push down through opening. Turn clockwise to seat. Filter cup will click in to place when seated properly. Do not operate dishwasher with loose or missing filters.

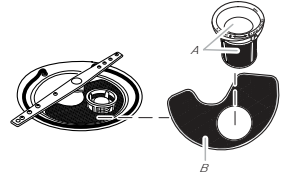

A. Upper Filter Assembly
B. Lower Filter

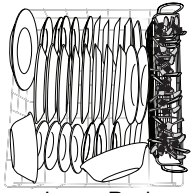

Lower Rack

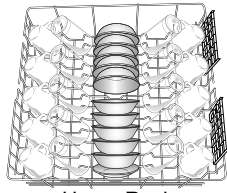

Upper Rack



Toss and Go Rack

NOTE: Racks vary by model.

- Make sure when the dishwasher door is closed that no items are blocking the detergent dispenser.
- Items should be loaded with soiled surfaces facing down and inward toward the spray, as shown in the graphics above.
- Avoid overlapping items like bowls or plates that may trap food.
- Place plastics, small plates, and glasses in upper rack.

NOTE: Silverware basket may vary by model.

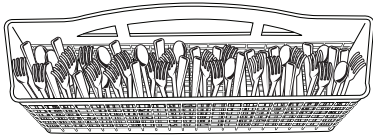

Silverware Basket

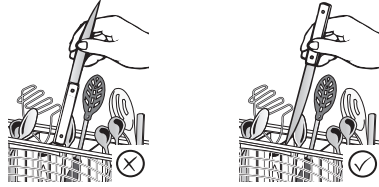

NOTE: Make sure no spray arms are blocked & are rotating freely.

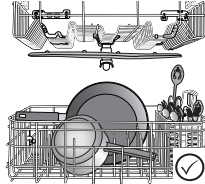
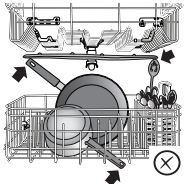

Step 2. Add Detergent

High-quality premeasured tablets and packs are recommended for improved performance.

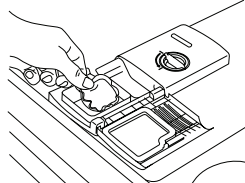
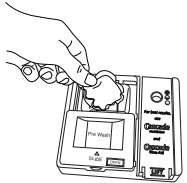

Step 3. Add Rinse Aid

Check the rinse aid indicator with the door down (varies by model). Add rinse aid when indicator drops to "Add" level or about every 1 to 3 months.

Add rinse aid to hinged lid-style dispenser by twisting the rinse aid cap 1/4 turn clockwise to open and lift off. Pour rinse aid into the opening until the indicator level is at "Full." Replace the rinse aid cap and turn to "Lock." Make sure cap is fully locked.

To add rinse aid to sliding lid-style dispenser, open the rinse dispenser lid by gently pushing in the center of the lid with your thumb and pulling up on the edge. Pour rinse aid into the opening until the dispenser is full. Then, close the dispenser by pushing down gently on the lid.

If you are experiencing poor drying performance, you may want to try a higher setting. Turn the arrow adjuster to a higher number to increase the amount of rinse aid.

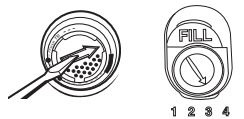
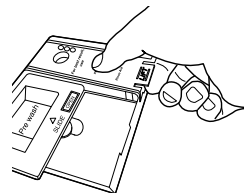
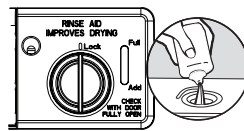

Step 4. Select Cycle & Option(s)

Please refer to Cycles & Options chart for more detailed description.

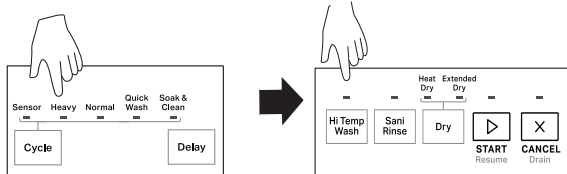

Step 5. Start or Resume a Cycle

IMPORTANT: If anyone opens the door (such as for adding a dish), the Start/Resume button must be selected each time.



Adjusting Racks:

You can raise or lower the middle rack to fit tall items in either the middle or bottom rack. Adjusters are located on each side of the middle rack. To raise the rack: Press both rack adjuster thumb levers and lift the rack until it is in the up position and level. To lower the rack: Press both rack adjuster thumb levers and slide the rack to its down position and level.

NOTE: The middle rack must be level. Remove dishes before adjusting rack.

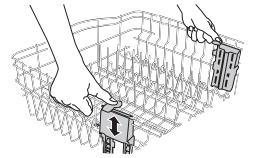

Height Adjustments (on some models)

FOLLOW THE PROGRESS OF YOUR DISHWASHER

The Clean indicator glows when a cycle is finished.

Cycle Guide

This information covers several different models. Your dishwasher may not have all of the cycles and options described.

NOTE: To repeat the same cycle and options used in the previous wash cycle, select Start twice.

| Cycles: | Descriptions: |
|---------------|---|
| Quick | For fast results, this cycle will clean dishes using slightly more water and energy. For improved drying, select a Heat Dry / Extended Dry option. NOTE: Some detergents are not recommended for short wash cycles; please refer to your detergent packaging for more information. |
| Normal | This dishwasher's government energy certifications were based on the Normal cycle with only the Heat Dry option selected. ** This cycle is recommended for daily, regular, or typical use to completely wash and dry a full load of normally soiled dishes. |
| Boost | This cycle is an enhanced Normal Cycle, and it uses more liters of water and heats it to a higher temperature throughout a longer cycle time to improve cleaning performance. Defaults to Extended Dry for improved drying. Includes a heated dry option.* |
| Heavy | Use for hard-to-clean, heavily soiled pots, pans, casseroles, and regular tableware. Defaults to Extended Dry for improved drying. Includes a heated drying option.* |
| Extended Soak | This cycle quietly soaks dishes with an extended prewash which eliminates the need to presoak dishes, saving personal time and effort. For optimal cleaning results during this cycle, add prewash detergent. Use this cycle for loads with heavy amounts of dried-on or hard-to-clean baked-on food. Defaults to Extended Dry for improved drying. Includes a heated drying option.* |
| Options: | Descriptions: |
| Heat Dry | Dries dishes with a heated dry cycle. Load Plastic items in upper racks. This dishwasher's government energy certifications were based on the Normal cycle with only the Heat Dry option selected. ** |
| Extended Dry | Increases the cycle time and temperature to provide improved dry performance over the heat dry option. For best drying results, use extended dry and rinse aid. Load plastic items in upper racks. |

*The government energy certifications are not based on this cycle and may increase your energy usage. See the Normal cycle description for the government energy certification cycle.

**No other washing and drying temperature options were selected, and the dishwasher was not subjected to truncated testing. Rinse aid was not used, and there was no detergent used in the prewash.

Online Ordering Information

For detailed installation instruction and maintenance information, winter storage, and transportation tips, please see the Owner's Manual included with your machine.

For information on any of the following items, a full cycle guide, detailed product dimensions, or for complete instructions for use, installation, and warranty, please visit <https://www.whirlpool.com/owners>, or in Canada <https://www.whirlpool.ca/owners>. This may save you the cost of a service call.

| Register Product | Schedule Service | How To's & FAQ | Manuals & Downloads | Add Service Plan | Parts | Accessories |
|--------------------|--|----------------|---|------------------|-------|-------------|
| | | | | | | |
| Accessories | To contact us, use the information listed below for the appropriate region. | | | | | |
| | United States: 1-866-698-2538 Whirlpool Brand Home Appliances Customer eXperience Center 553 Benson Road Benton Harbor, MI 49022-2692 | | Canada: 1-800-807-6777 Whirlpool Brand Home Appliances Customer eXperience Centre 200-6750 Century Ave. Mississauga, Ontario L5N 0B7 | | | |

Please scan the QR code to access the installation videos & the online-only items.

